

Site Details:

BURROUGHS ROAD, RATBY,
LE6 0LN

Client Ref: 23120_-3982415
Report Ref: GS-87W-J6P-1G3-NUV_LS_2_2
Grid Ref: 450930, 306343

Map Name: National Grid

Map date: 1968

Scale: 1:2,500

Printed at: 1:2,500



Surveyed 1968
Revised 1968
Edition N/A
Copyright 1969
Levelled 1964



Produced by
Groundsure Insights
T: 08444 159000
E: info@groundsure.com
W: www.groundsure.com

© Crown copyright and database rights 2018 Ordnance Survey 100035207

Production date: 27 October 2023

Map legend available at:
www.groundsure.com/sites/default/files/groundsure_legend.pdf

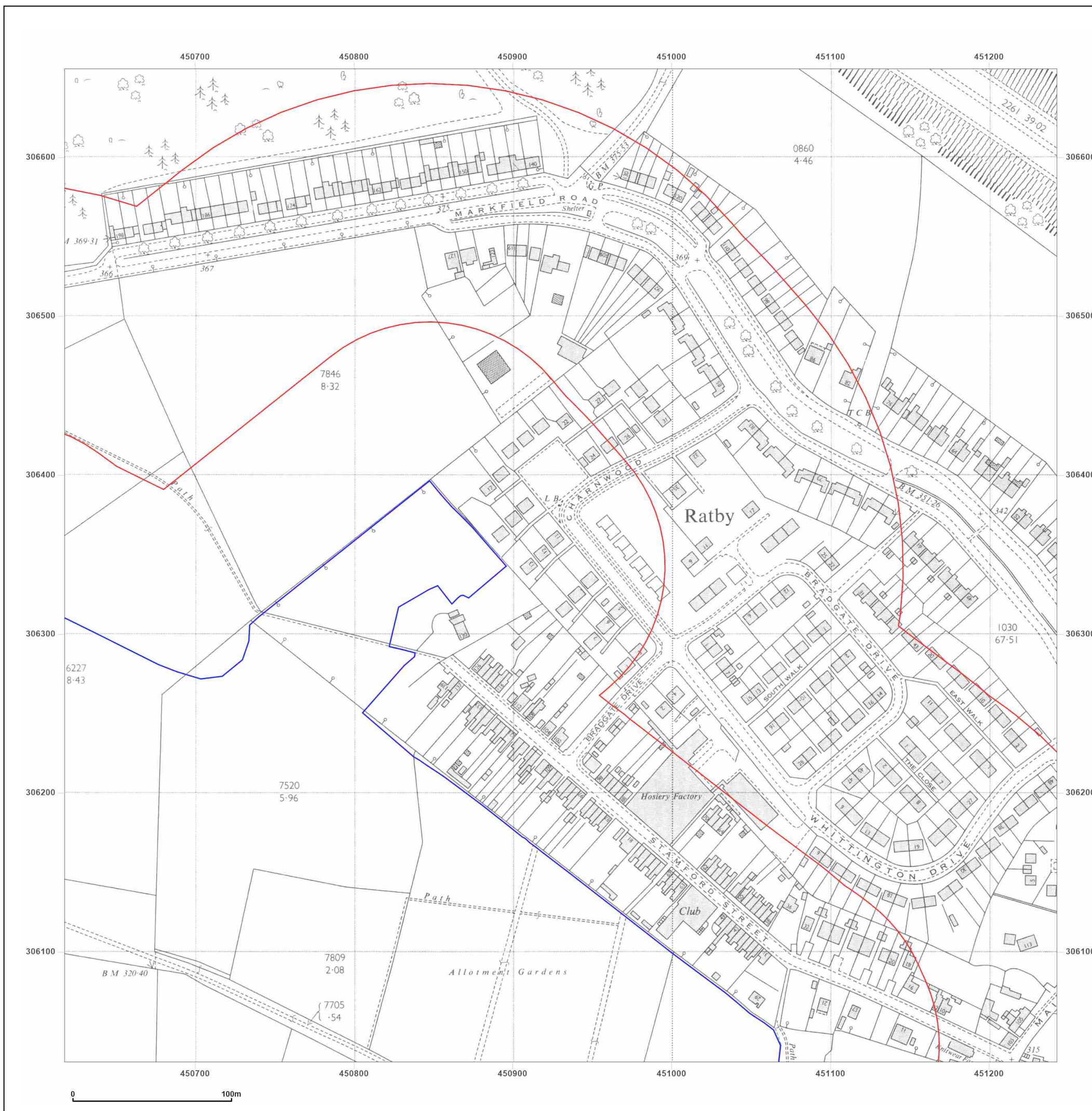

Site Details:

BURROUGHS ROAD, RATBY,
LE6 0LN

Client Ref: 23120_- 3982415
Report Ref: GS-87W-J6P-1G3-NUV_LS_2_2
Grid Ref: 450930, 306343

Map Name: National Grid

Map date: 1969

Scale: 1:2,500

Printed at: 1:2,500

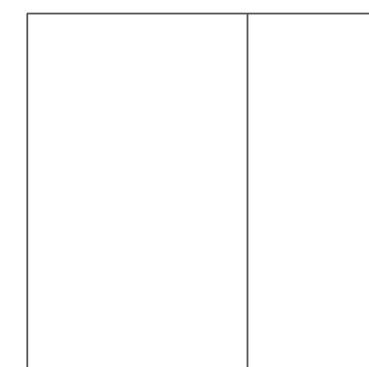

Surveyed N/A
Revised N/A
Edition N/A
Copyright N/A
Levelled N/A



Produced by
Groundsure Insights
T: 08444 159000
E: info@groundsure.com
W: www.groundsure.com

© Crown copyright and database rights 2018 Ordnance Survey 100035207

Production date: 27 October 2023

Map legend available at:
www.groundsure.com/sites/default/files/groundsure_legend.pdf



Site Details:

BURROUGHS ROAD, RATBY,
LE6 0LN

Client Ref: 23120_-3982415
Report Ref: GS-87W-J6P-1G3-NUV_LS_2_2
Grid Ref: 450930, 306343

Map Name: National Grid

Map date: 1977

Scale: 1:2,500

Printed at: 1:2,500

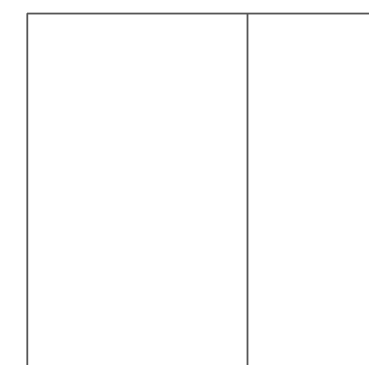

Surveyed N/A
Revised N/A
Edition N/A
Copyright N/A
Levelled N/A



Produced by
Groundsure Insights
T: 08444 159000
E: info@groundsure.com
W: www.groundsure.com

© Crown copyright and database rights 2018 Ordnance Survey 100035207

Production date: 27 October 2023

Map legend available at:
www.groundsure.com/sites/default/files/groundsure_legend.pdf

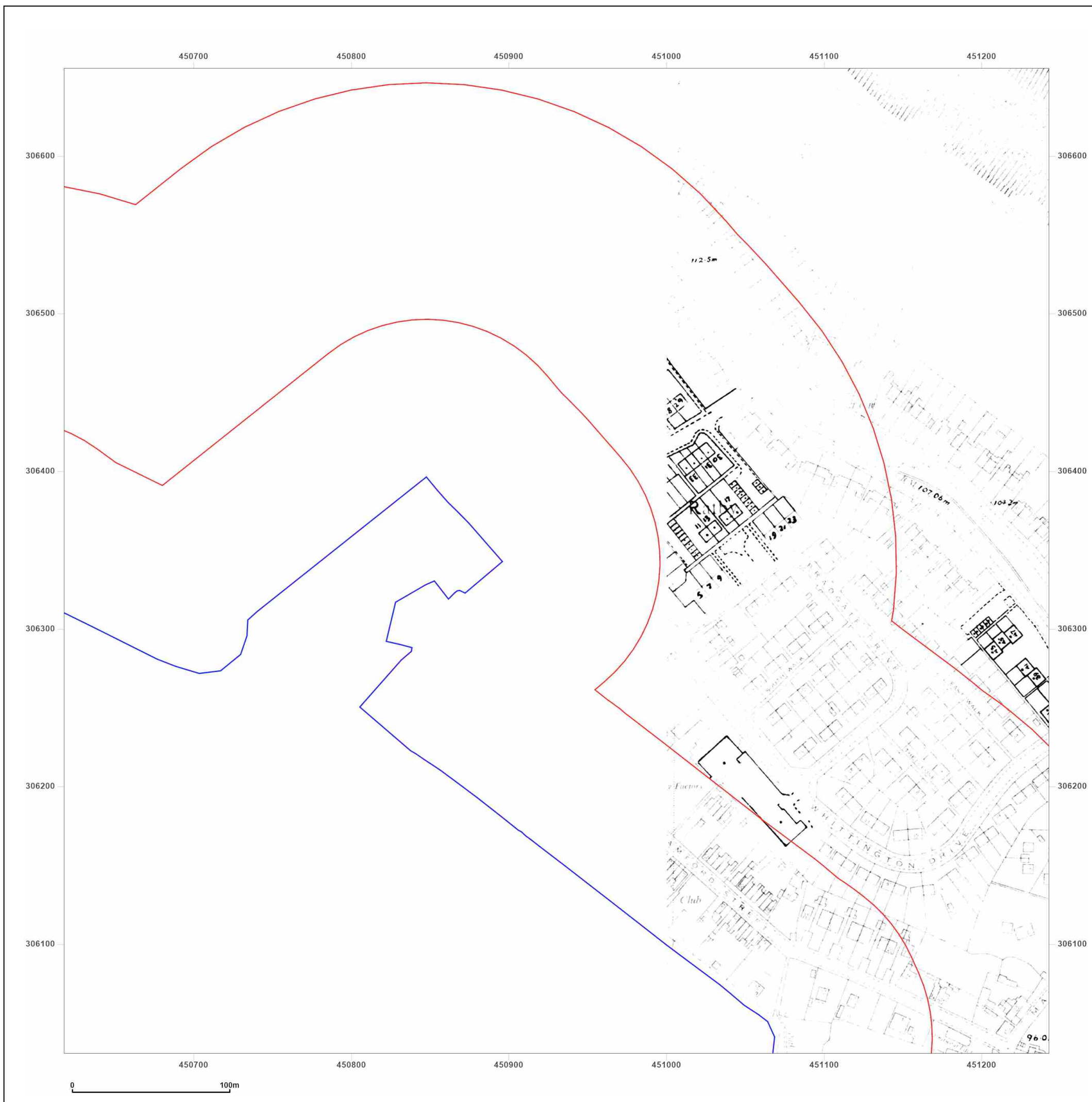

Site Details:

BURROUGHS ROAD, RATBY,
LE6 0LN

Client Ref: 23120_-3982415
Report Ref: GS-87W-J6P-1G3-NUV_LS_2_2
Grid Ref: 450930, 306343

Map Name: National Grid

Map date: 1974-1978

Scale: 1:2,500

Printed at: 1:2,500



Surveyed 1964
Revised 1978
Edition N/A
Copyright 1978
Levelled 1964

Surveyed N/A
Revised N/A
Edition N/A
Copyright N/A
Levelled N/A



Produced by
Groundsure Insights
T: 08444 159000
E: info@groundsure.com
W: www.groundsure.com

© Crown copyright and database rights 2018 Ordnance Survey 100035207

Production date: 27 October 2023

Map legend available at:
www.groundsure.com/sites/default/files/groundsure_legend.pdf



Site Details:

BURROUGHS ROAD, RATBY,
LE6 0LN

Client Ref: 23120_-3982415
Report Ref: GS-87W-J6P-1G3-NUV_LS_2_2
Grid Ref: 450930, 306343

Map Name: National Grid

Map date: 1984

Scale: 1:2,500

Printed at: 1:2,500

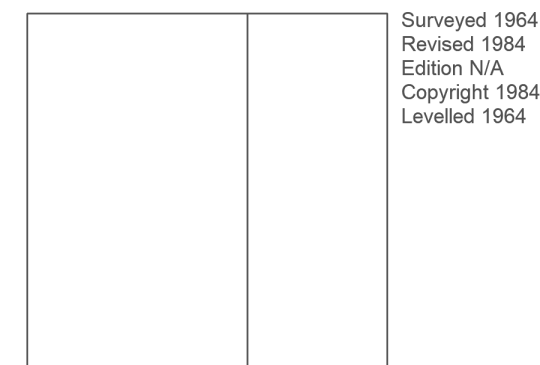

Surveyed 1964
Revised 1984
Edition N/A
Copyright 1984
Levelled 1964



Produced by
Groundsure Insights
T: 08444 159000
E: info@groundsure.com
W: www.groundsure.com

© Crown copyright and database rights 2018 Ordnance Survey 100035207

Production date: 27 October 2023

Map legend available at:
www.groundsure.com/sites/default/files/groundsure_legend.pdf

Site Details:

BURROUGHS ROAD, RATBY,
LE6 0LN

Client Ref: 23120_-3982415
Report Ref: GS-87W-J6P-1G3-NUV_LS_2_2
Grid Ref: 450930, 306343

Map Name: National Grid

Map date: 1990

Scale: 1:2,500

Printed at: 1:2,500



Surveyed 1990
Revised 1990
Edition N/A
Copyright 1991
Levelled N/A

Surveyed 1990
Revised 1990
Edition N/A
Copyright 1991
Levelled N/A



Produced by
Groundsure Insights
T: 08444 159000
E: info@groundsure.com
W: www.groundsure.com

© Crown copyright and database rights 2018 Ordnance Survey 100035207

Production date: 27 October 2023

Map legend available at:
www.groundsure.com/sites/default/files/groundsure_legend.pdf

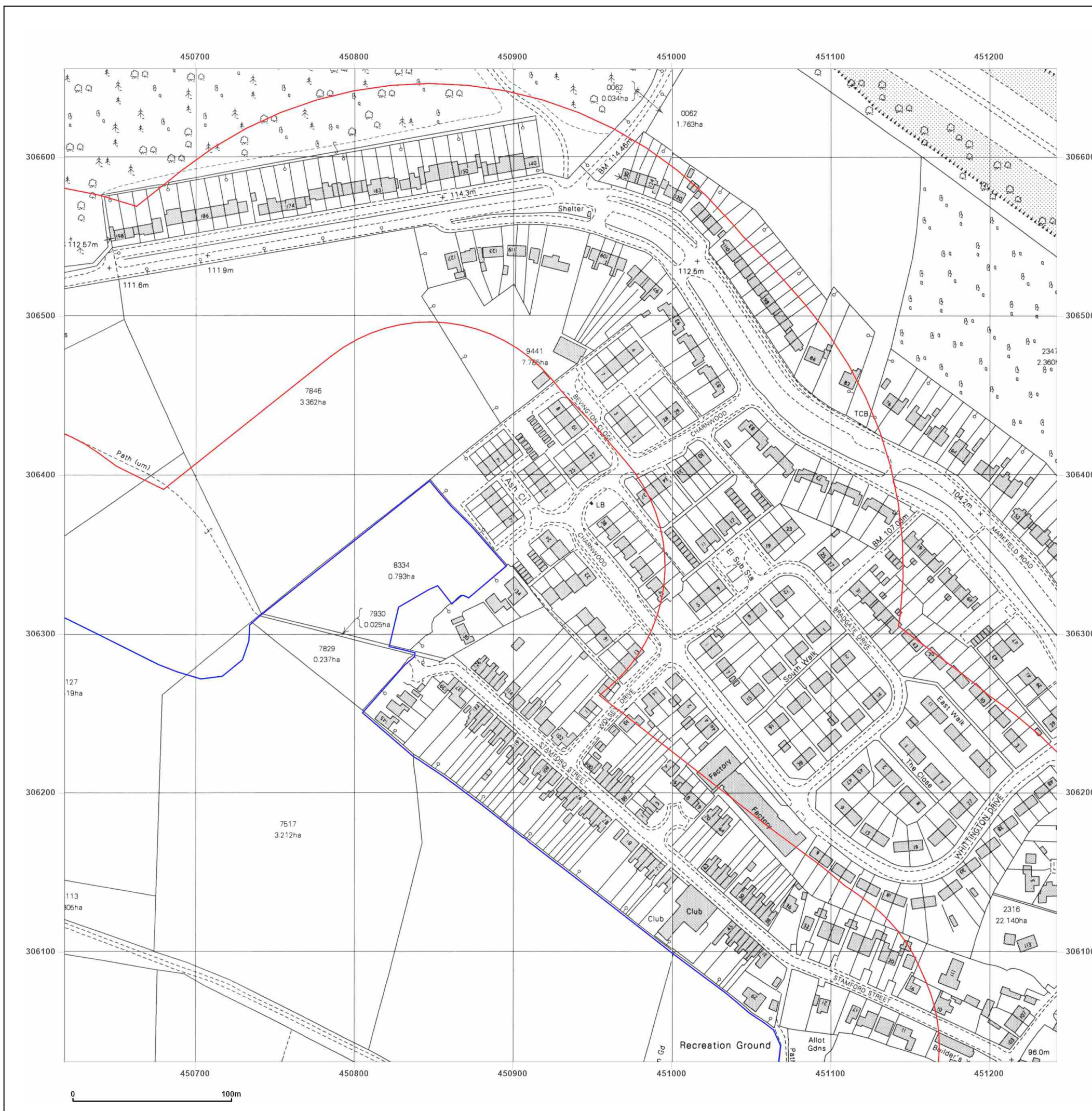

Site Details:

BURROUGHS ROAD, RATBY,
LE6 0LN

Client Ref: 23120_-3982415
Report Ref: GS-87W-J6P-1G3-NUV_LS_2_2
Grid Ref: 450930, 306343

Map Name: National Grid

Map date: 1994

Scale: 1:2,500

Printed at: 1:2,500



Surveyed N/A
Revised N/A
Edition N/A
Copyright 1994
Levelled N/A

Surveyed N/A
Revised N/A
Edition N/A
Copyright 1994
Levelled N/A



Produced by
Groundsure Insights
T: 08444 159000
E: info@groundsure.com
W: www.groundsure.com

© Crown copyright and database rights 2018 Ordnance Survey 100035207

Production date: 27 October 2023

Map legend available at:
www.groundsure.com/sites/default/files/groundsure_legend.pdf

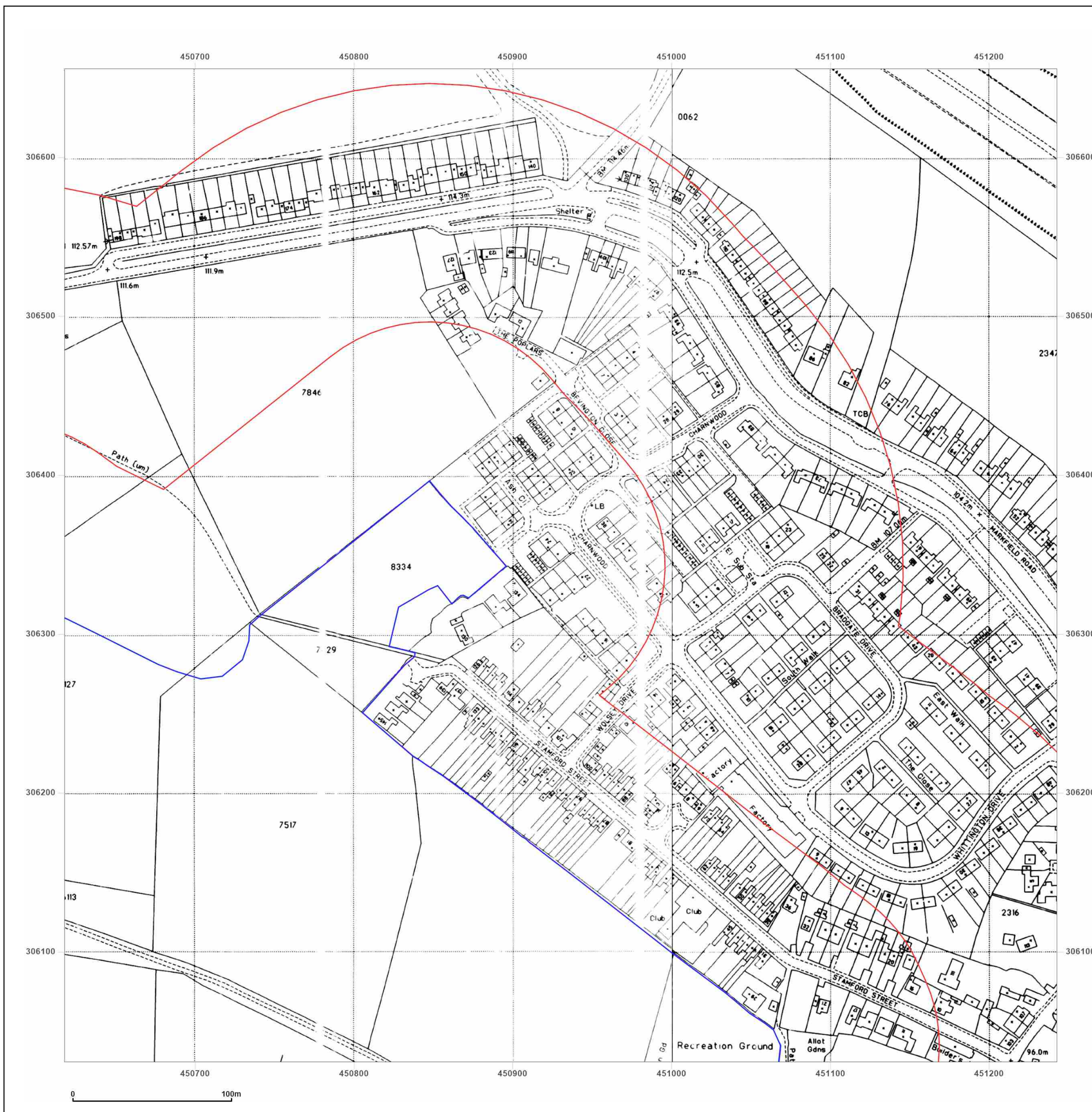

APPENDIX 3
Selection of Site Photographs

WEST RATBY, BURROUGHS ROAD, RATBY

Appendix 3 – Photographs Taken During Site Reconnaissance (12 October 2023)



Looking west from the south of field 13



Looking west from the north east of field 1



Looking west from the north of field 7



Looking east from the south of field 8

WEST RATBY, BURROUGHS ROAD, RATBY

Appendix 3 – Photographs Taken During Site Reconnaissance (Field 1)



Looking south east at a small mound adjacent to the site entrance of field 1



Looking north at the entrance to field 1



Closer look at drainage ditch along east boundary of field 1



Looking south west from the south east of field 1



Looking west from the south of the site



Looking south from the approximate centre of field 1



Looking east at the slope in the south of field 1



Looking north (offsite along public footpath) at the bank of the stream immediately south of the site

WEST RATBY, BURROUGHS ROAD, RATBY

Appendix 3 – Photographs Taken During Site Reconnaissance (Field 2)



Looking north west at the entrance to field 2 from field 1



Looking north east from the approximate centre of the west boundary at field 2



Looking north from the approximate centre of the southern boundary in field 2 at ridge and furrow features



Looking east from the approximate centre of the southern boundary of field 2



Looking to the south east off field 2



Looking west from the north east of field 2



Looking south from the north west of field 2



Looking at the entrance to field 2 from field 3

WEST RATBY, BURROUGHS ROAD, RATBY

Appendix 3 – Photographs Taken During Site Reconnaissance (Field 3)



Looking west from the site entrance to field 3



Looking east from the entrance to field 3



Looking west from the north east of field 3



Looking south east from the north west of field 3 showing ridge and furrow features