

## Arboricultural Appraisal Report

Impact Assessment & Method Statement to Inform Development

*BS5837:2012 Trees in relation to Design, demolition and construction – Recommendations*

Lindridge Lane  
Desford  
LE9 9GN



CLIENT:	XL Designs (Midlands) Ltd
MWA REF:	DEV251031-1356
MWA CONSULTANT:	Ben Edmonds <i>BSc MA ArborA</i>
REPORT DATE:	17/11/2025

MWA Arboriculture Ltd  
Bloxham Mill Business Centre  
Barford Rd, Bloxham  
Banbury  
OX15 4FF

MWA Arboriculture Ltd  
Unit 8 Stephenson House  
Horsley Business Centre  
Horsley  
Newcastle Upon Tyne  
NE15 0NY

Tel: 0800 6129452  
Email: [office@mwaarboriculture.co.uk](mailto:office@mwaarboriculture.co.uk)

## Technical Summary

Proposal summary: Construction of four semi-detached and one detached property with double garage.

See supervision statement regarding direct supervision of works and monitoring.

**Table 1: Summary of Tree works Summary**

Vegetation Works Summary	Vegetation Affected by Category			
	Cat A	Cat B	Cat C	Cat U
Removal under sound arboricultural management	0	0	0	4
Removal due to development	0	0	1	0
Pruning (Enabling Works)	0	0	0	0

**Table 2: Mitigation Requirements Summary**

Mitigation Requirements Summary	Vegetation Affected by Category			
	Cat A	Cat B	Cat C	Cat U
Protective Fencing	See MWA Protection Plan			
Ground Protection	0	2	2	0
Excavation within RPAs	0	1	1	0
No Dig Installation	0	1	0	0

**Table 3: List of Vegetation Works and Mitigation**

Works / Mitigation	Vegetation Affected
Removal	T01, T18, T20, T21, T22
Pruning	None
Protective Fencing	See MWA Tree Protection Plan
Ground Protection	T04, T13, T15, T16
Excavation within RPAs	T04, T13
No Dig Installation	T23

## Contents

Introduction .....	2
1 Scope .....	2
2 Supporting Documents .....	3
3 Components of Report .....	3
Site Assessment .....	4
4 Statutory Controls, Policy and other Constraints .....	4
5 Tree Survey .....	5
6 Site Description.....	6
7 Tree Constraints Plan.....	7
Development Appraisal.....	8
8 Development Proposal .....	8
9 Arboricultural Impact Assessment.....	8
Arboricultural Method Statement .....	10
10 Arboricultural Method Statement (subject to revision if planning conditions are imposed) ....	10
11 Construction Phase.....	13
12 Sequencing of works & supervision.....	17
13 Conclusions .....	18

Appendix 1 – Key Contacts

Appendix 2 -Images

Appendix 3 – Site Monitoring Form

Appendix 4 – Example handout for site operatives when working with RPAs

---

## **Introduction**

### **1 Scope**

- 1.1 The scope of this report is limited to an appraisal of the existing significant vegetation on (and/or adjoining) the site and identification of the implications of development on retained vegetation in accordance with our instruction. The assessment is to be made with reference to BS 5837:2012 'Trees in Relation to design, demolition and construction – Recommendations'. This report is based on conditions found at the time of our survey.
- 1.2 To prepare clear recommendations supported by relevant plans and data in order to facilitate consideration of the arboricultural implications by the Local Planning Authority (LPA).
- 1.3 To consider the development proposals, identify areas where there are arboricultural issues and to recommend possible solutions.
- 1.4 To consider additional information supplied, to identify arboricultural issues arising from this information and to recommend possible solutions.
- 1.5 No responsibility is assumed by MWA Arboriculture Ltd for legal matters that may arise from this report, and the consultant shall not be required to give testimony or to attend court unless additional contractual arrangements are made.
- 1.6 This report is not a Tree Risk Management Report or a Hazard Analysis Report and its use as such is invalid.
- 1.7 The vegetation has been assessed from ground level only. Assessment of condition is based on a visual tree assessment (VTA). No detailed inspection of the upper crown has been carried out. No decay detection equipment (destructive or non-destructive) has been used to further assess the condition of the vegetation, which is beyond the scope of the survey. Any dangerous trees requiring further assessment on safety grounds will be identified.
- 1.8 Due to the changing nature of trees and other site circumstances this report, and any recommendations made are limited to a 3-year period. Any alteration to the application site or any development proposals could change the current circumstances and may invalidate this report and any recommendations made. Should this be the case this report will require revision to reflect the development proposals.
- 1.9 A lack of recommended work does not imply that a tree is safe and likewise it should not be implied that a tree will be made safe following the completion of any recommended work.
- 1.10 All measuring instruments were used in accordance with appropriate user guides.
- 1.11 No site investigations to identify underlying soils and geology have been undertaken. This information may have a bearing upon existing and proposed foundations and landscape design. The project engineer is to be consulted regarding impacts from the recommendations contained within this report.

- 
- 1.12 Any legal description or information given to MWA Arboriculture Ltd is believed to be accurate.
- 1.13 Where solutions to arboricultural problems are specified which require the usage of a third-party product e.g., no dig roadway construction, no liability is assumed for the performance or suitability of the product and specialist advice as to the suitability or installation of the product should be sought from the manufacturer or other specialist.
- 1.14 No responsibility is assumed by MWA Arboriculture Ltd for legal matters that may arise from this report, and the consultant shall not be required to give testimony or to attend court unless additional contractual arrangements are made.
- 1.15 Any alteration or deletion from this report shall invalidate it as a whole.

## **2 Supporting Documents**

- 2.1 We have been supplied with: The topographical survey drawing; 25.330.OS2\_DRAFT ISSUE (Location Plan); 25.330.O1, 02\_DRAFT ISSUE (Proposed Site Plan); 25.330.BP02\_DRAFT ISSUE (Block Plan) files showing the existing situation and the proposals. Tree locations were plotted from a topographical survey.

## **3 Components of Report**

- 3.1 This report comprises the following elements:

### Site Assessment

- Baseline tree survey of vegetation that may be impacted by proposals
- Description of the site
- Assessment of existing vegetation / tree stock
- Tree Survey Schedule (TS)

### Development Appraisal

- Description of proposed development
- Arboricultural Impact Assessment
- Tree Constraints Plan (TCP)

### Arboricultural Method Statement

- Arboricultural Method Statement (AMS) - preliminary
- Tree Protection Plan (TPP)

## **Site Assessment**

### **4 Statutory Controls, Policy and other Constraints**

- 4.1 A check with Hinckley and Bosworth Borough Council interactive map returned that no trees on the site are subject to a Tree Preservation Order (TPO) and the site is not located within a Conservation Area (CA).

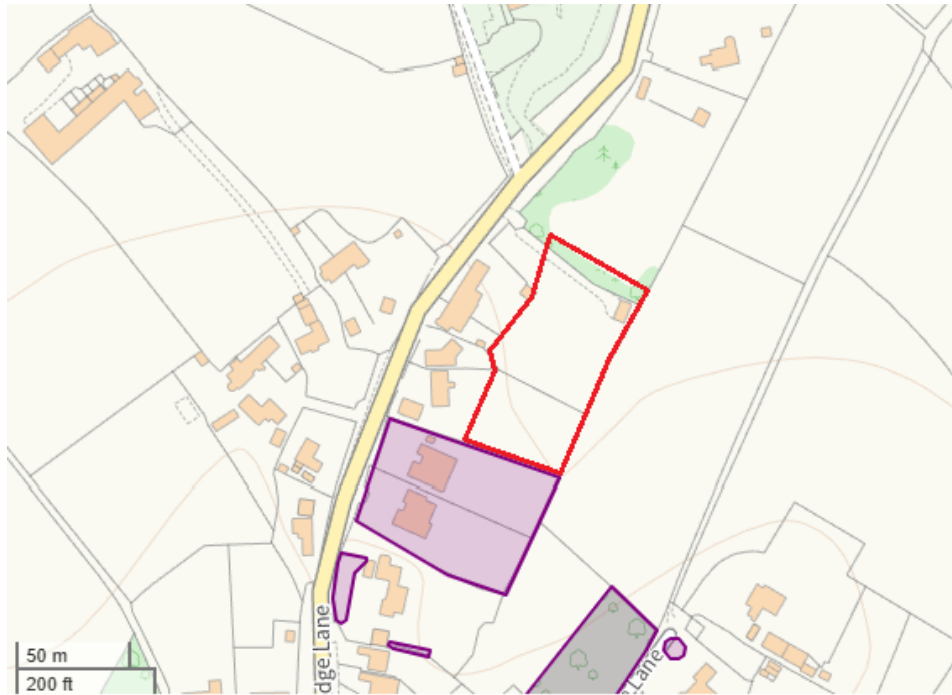

Figure 1: Screen shot from: <https://www.hinckley-bosworth.gov.uk/tpomap>  
TPO's mapped as lilac coloured polygons and approximate site outlined in red.

- 4.2 It would not therefore be necessary to inform the Local Planning Authority (LPA) before working on trees within or adjacent to the site, and to request permission to conduct works that may impact the offsite TPO trees.
- 4.3 National planning policy is set out in the revised National Planning Policy Framework (NPPF) December 2024 and trees on this site should be considered against the information contained in Section 15 "Conserving and enhancing the natural environment". Trees can also contribute to historical character and settings and where this is the case Section 16 "Conserving and enhancing the historic environment" would also be relevant.
- 4.4 Hinkley & Bosworth Climate Change and Biodiversity Strategy 2024-2028 states; A core objective is to "Work towards an increased tree canopy in the borough". The Heritage Strategy also links the historic environment to planning and development, which includes the landscape setting of historic assets.

---

## 5 Tree Survey

- 5.1 The survey was conducted on 14/11/2025. The weather was wet and windy. A total of twenty-three individual trees, one hedge and one group of trees were recorded during the survey.
- 5.2 This type of survey is not expected to include all vegetation, but all trees with a stem diameter in excess of 75mm at 1.5m from the ground should be included. Substantial hedges and similar large collections should also be included, but areas such as planting beds with annual or herbaceous species would not be relevant to the survey. The terms 'tree' and 'vegetation' are used interchangeably in this document.
- 5.3 Vegetation was assessed in accordance with Sections 4.4 and 4.5 of BS 5837:2012. Under this system trees are allocated a retention category based upon their quality and value in the existing context. These are:
- Category A – trees of high quality with long term future potential;
  - Category B – trees of moderate quality with medium term future potential;
  - Category C – trees of low quality with short term future potential;
  - Category U – trees in such a condition that they cannot be realistically be retained as living trees for longer than 10 years.
- 5.4 Category U trees may be upgraded if they have identifiable conservation, heritage or landscape value, but only where this does not compromise safety.
- 5.5 Seven trees and one group were assigned Category B for their individual merits.
- 5.6 Four trees were assigned Category U due to their current condition and low expected future contribution. These should be removed irrespective of any development.
- 5.7 The remaining surveyed vegetation was classified as category C. Category C trees are low quality trees, while classified as low-quality trees, their retention could still offer a significant asset to any proposed development.
- 5.8 Tree locations were plotted from a topographical survey.
- 5.9 The survey information is provided in graphical form in plan no. MWA TCP 01 and in tabular form in MWA TS 01 Tree Survey Schedule.

## 6 Site Description

- 6.1 The parcel of land is located to the north of Desford, forming the rear boundary interface with existing residential properties on Lindridge Lane. The north of the site is undergoing construction for a development of four detached residential units. The undeveloped southern portion is laid to grass (paddock/garden) and is screened along its eastern boundary by a significant line of mature trees, which contribute to the local green infrastructure.



*Figure 3: Screen shot from Google Earth showing existing Situation approximate site outlined in red.*

- 6.2 There are limited trees in the centre of the site with plenty of area that could be developed without adversely impacting any trees.
- 6.3 There are several trees in poor condition that are recommended to be removed irrespective of the development. The removal of these trees would make further space for the proposed development.
- 6.4 The southwest boundary consists of a line of deciduous trees, these frame the plot and provide screening from the agricultural fields to the west.

---

## 7 Tree Constraints Plan

- 7.1 The Tree Constraints Plan (TCP) shows that vegetation which we consider could be justifiably removed to provide room for proposed development and set back lines which would allow the remaining vegetation to be retained. Constraints identified should be respected where possible, but these reflect only the arboricultural constraints on the site and other considerations may supersede these requirements in order to deliver a robust design which balances all of the needs arising from planning policy and development operations.
- 7.2 Vegetation / trees identified as justifiable removals are those trees whose removal can be justified in arboricultural terms in a development context. Such vegetation would include that with significant defects which should be removed under sound arboricultural management, species unsuited to the revised context or those whose benefits could be readily replaced with appropriate planting.
- 7.3 Just because a tree has been identified as a justifiable removal does not mean that the tree should or will be removed. It is simply that these trees should not be considered a constraint to good design. All trees should be retained within a development if this is practicable, but it is sometimes not possible and the identification of trees which could be removed enables those of higher value to be clearly identified and accommodated within the scheme at an early stage.

## **Development Appraisal**

### **8 Development Proposal**

- 8.1 The proposal is for the construction of four detached properties with two detached garages. New planting is proposed to mitigate the loss of any trees and increase the biodiversity of the site.

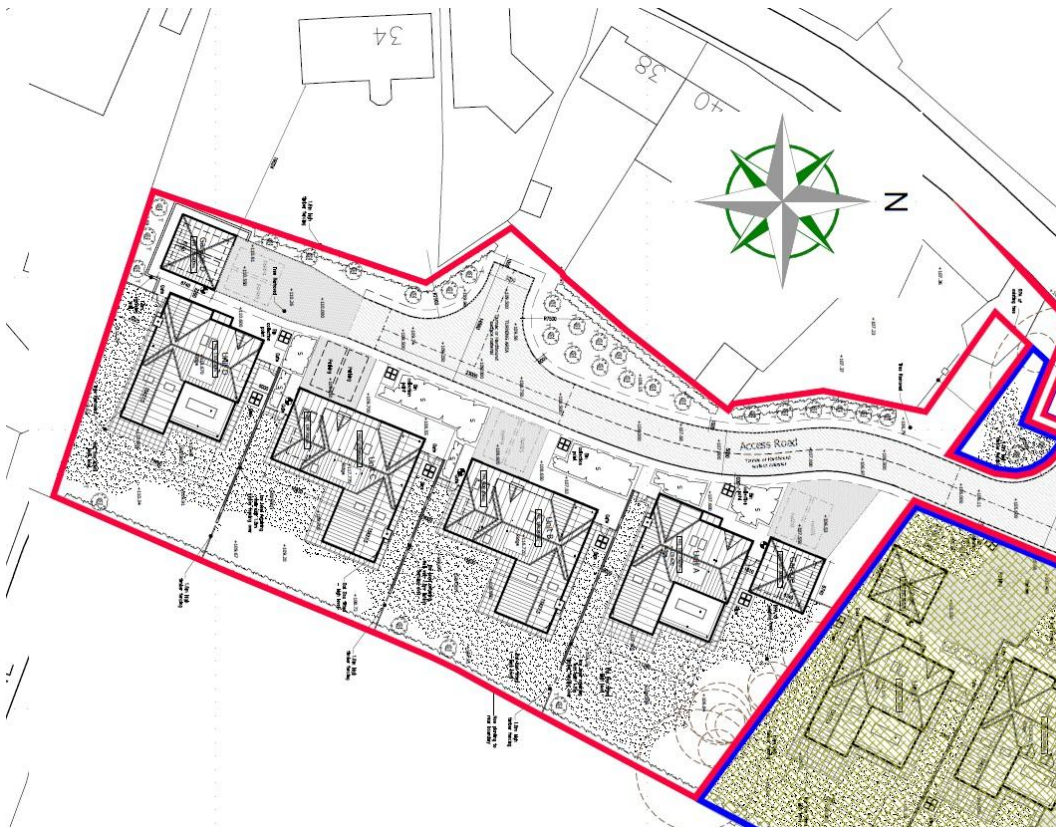

*Figure 4: Proposed Situation*

### **9 Arboricultural Impact Assessment**

- 9.1 This appraisal is made in the context of a potential development. It therefore seeks to identify vegetation that would form a constraint to development, that vegetation that would need to be removed, assess impacts from the proposals and define measures to assist in the long-term retention of retained tree stock. The assessment does not consider the requirements of other disciplines such as highways or drainage.
- 9.2 Our assessment of the arboricultural component of the site is presented in the associated documents MWA TS 01 Tree Survey Schedule. MWA TCP 01. Our assessment of the proposed scheme is shown in associated plan MWA TPP 01. The assessments consider tree location, ground conditions, likely root morphology, current dimensions, future growth and the proposed setting. The tolerance of the trees to disturbance based on species, age, condition and the presence of surrounding trees and / or built form is also considered.

---

9.3 **Above ground impacts:**

9.4 Five trees have been recommended to be removed, four trees to enable the development (T01, T20, T21 & T22) and one tree (T18) because it is in poor condition. Of the five trees four are in poor condition and have been recommended to be removed irrespective of the development. The crab apple tree T22 has been classified as a C category tree and while in a reasonable condition should not be seen as a restraint on development.

9.5 Issues surrounding shading and the pressure for future tree works/removals are not judged to be significant due to the sensible proximities of retained trees to the new dwellings and relatively open and roomy nature of the development.

9.6 The installation of protective fencing will adequately address the threat of direct above ground damage during the development process.

9.7 **Below ground impacts:**

9.8 The majority of the proposed development (parking bays and hard standing) do not infringe the root protection areas of retained trees to a significant degree. Where the proposed parking bays do infringe the root protection areas of retained trees no-dig surfacing and a permeable wearing layer is specified.

9.9 The root plate is the area of roots immediately adjacent to the trunk which supplies mechanical support and damage to this area can result in collapse of the tree. The wider root system supplies nutrients and water to the tree. Loss of some of these roots can be tolerated by most species, but if too large an amount is lost then the tree can be seriously affected and could potentially die.

9.10 Threat from indirect damage and impacts on the rooting environment of retained trees is addressed, where practicable, by erection of protective fencing in accordance with the AMS.

9.11 We currently have no information relating to the provision of services to the new buildings. In order to safeguard retained vegetation we advise that any excavation undertaken within the RPA of retained trees is supervised by a competent arboriculturist and that any root pruning which may be necessary is undertaken in accordance with NJUG10.

---

## **Arboricultural Method Statement**

### **10 Arboricultural Method Statement (subject to revision if planning conditions are imposed)**

10.1 Our assessment identifies that the proposed development will require works to be conducted within the RPAs of retained trees based on the current information. Extra care is therefore required to prevent damage to retained trees.

10.2 The following sections provide information relating to the order of implementation and proposed works. This assessment is based upon the plans available at the time of writing. As such the recommendations below may be subject to revision in response to additional information or revisions required to discharge planning conditions.

#### **10.3 Restrictions to operations within RPAs**

10.4 Where development activities occur within the RPAs of retained vegetation the following shall apply within the RPA:

- All excavation will be by hand and completed under direct arboricultural supervision of the project arboriculturist, following a written method statement that has first been approved by the local planning authority.
- No mechanical excavation is to take place within the RPA. In some circumstances it may be permissible under strict arboricultural site supervision and with a site-specific method statement.
- No lowering of levels for any purpose (except removal of grass sward using hand tools).
- No storage of plant or materials.
- No storage or handling of any chemical including cement washings.
- No vehicular access unless specified when those needed for construction works such as light diggers, mini dumper mini piling machinery shall advance only over ground protection or existing hard surfaces (if present) subject to loads.
- No substances injurious to tree health, including fuels, oil, bitumen, cement (including cement washings), builders' sand, concrete mixing and other chemicals shall be stored or used within or directly adjacent to the protection area of retained trees.
- No fire is permitted at any time.
- Whacker plates will not be used within the RPAs of retained trees. Non vibrating rollers will be used to compact materials if required. Hand tampers should be avoided as they can also damage roots, but these may be employed if access prevents the use of a roller.

10.5 Care shall be taken when planning site operations in proximity of retained trees to ensure that wide or tall loads, or plant with booms, jibs and counterweights, can operate without coming into contact with retained trees. Such contact can result in serious injury to them and might make their safe retention impossible. Consequently, any transit or traverse of plant in proximity of trees shall be conducted under the supervision of a banksman, to ensure that adequate clearance from trees is at all times maintained.

#### 10.6 **Enabling works**

10.7 A pre-commencement meeting will be held to discuss phasing of works and appropriate practices where works are to be conducted within RPAs. This meeting will include the site agent and project arboriculturist.

10.8 Works to vegetation detailed in the Tree Protection Plan MWA TPP 01 will be completed before any other activity is conducted on the site.

10.9 Fencing will be erected and ground protection installed as shown in the Tree Protection Plan, MWA TPP 01, as far as existing structures will allow. This will conform the full specification shown below, but rubber feet may be used if site constraints prevent the use of the full bracing. All weather notices will be attached to the barriers stating that no access is permitted to the fenced area; an example is also shown below.

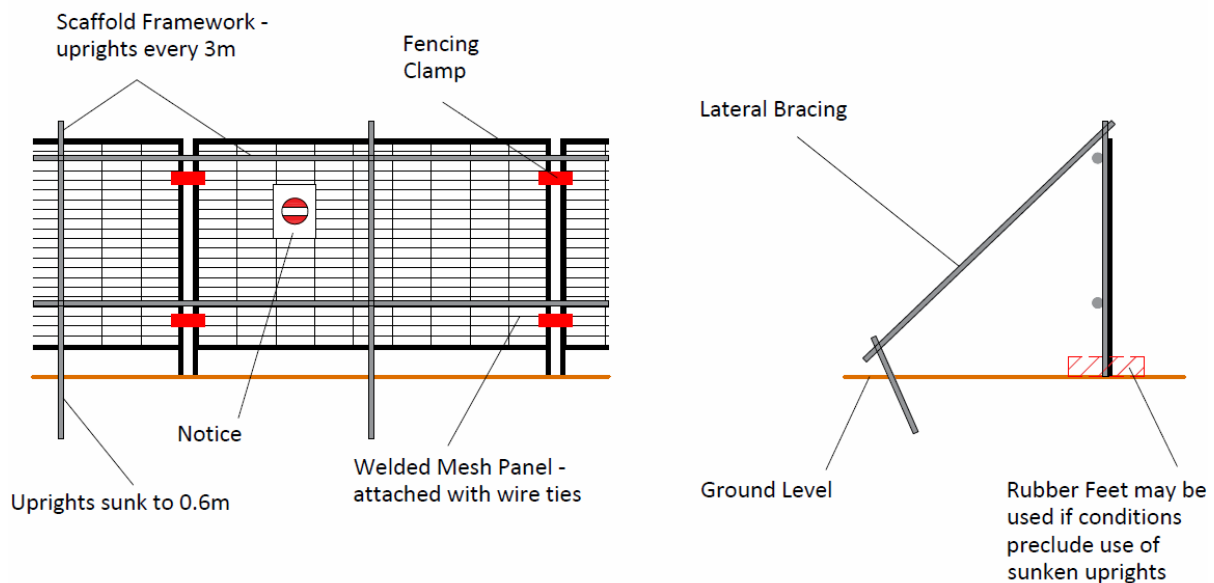
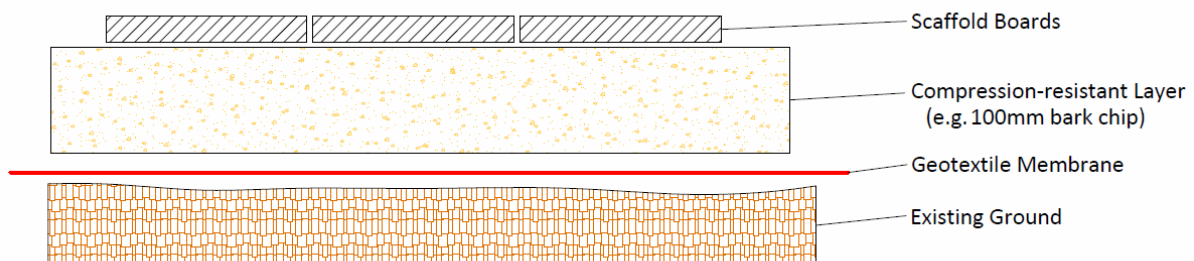

*Figure 5: Fencing Specification*



*Figure 6: Fencing Warning Sign*

10.10 Temporary ground protection will be deployed in areas where full protective fencing is not feasible or must be temporarily removed for construction access. The affected areas include the northwest zone of Unit A (T04) and the southwest zone of Units B and C (T13–T16). The specification of the ground boarding shown is illustrative for pedestrian access only; the chosen system must be verified against the required load-bearing capacity for all expected site traffic.



*Figure 7: Ground Protection Schematic*



*Figure 8: Ground Protection Example.*

## 11 Construction Phase

- 11.1 Protective fencing and other measures shown will be maintained in accordance with agreed plans for the duration of each particular phase / operation or until construction is complete (as applicable). No changes are permitted without consultation with the project arboriculturist and agreement of the Tree Officer.
- 11.2 The proposed drive and turning area, positioned opposite Units C and D, is designed to encroach into the Root Protection Area (RPA) of Tree T23. The proposal impacts an area equivalent to approximately 10–15% of T23's RPA. This minor encroachment is considered tolerable, especially given the recent significant reduction in the tree's crown, which is assumed to have resulted in a proportionate reduction of the functional root zone.
- 11.3 To ensure the long-term health and integrity of the tree's roots, the drive within the RPA will be constructed using a non-dig cellular confinement system. This technique will be employed specifically to avoid the need for any excavation or ground works, thereby eliminating potential damage to the rooting environment and providing additional, long-term protection to Tree T23.
- 11.4 The Tree Protection Fencing must remain in place in accordance with the TPP until the final landscaping phase. Once the main development has been completed the Tree Protective Fencing can be moved to allow the cellular confinement system to be installed according to the manufacturer's specification.
- 11.5 Further information regarding these systems is provided within the Arboricultural Association Guidance Note 12 'The use of cellular confinement systems near trees: A guide to good practice'.
- 11.6 A diagrammatic cross section of a typical cellular confinement system is shown below:

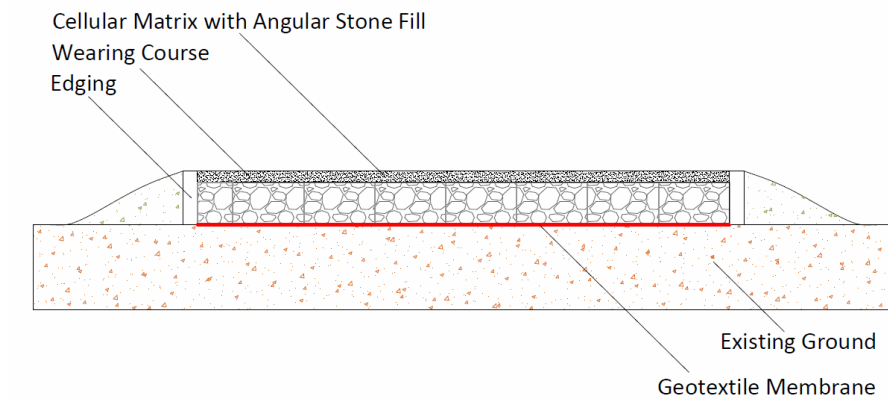

*Figure 9: Cellular Confinement System Schematic*

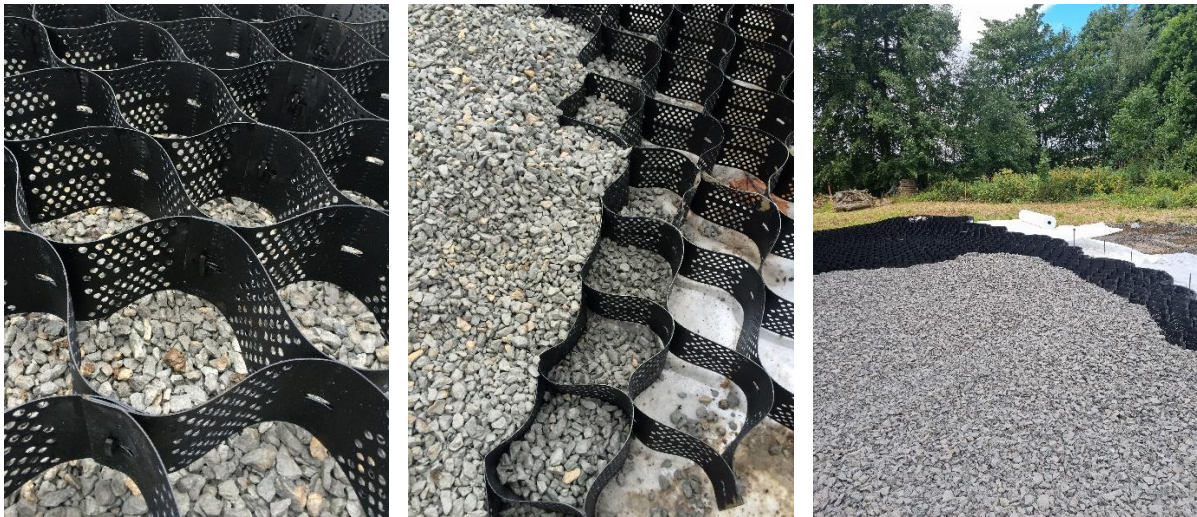

*Figure 10: Cellular Confinement System Examples*

**11.7 Excavations within the RPA**

- 11.8 The current scheme includes specific, minor excavation works that encroach into the RPA's allocated to Tree T04 and Tree T13.
- 11.9 Manual excavation seeks to avoid this damage by exposing roots before severance and cutting them cleanly using appropriate tools when necessary. Exposed root ends are minimised and can be better protected from incidental damage.
- 11.10 Typically, 82% of the roots of broadleaved trees and 70% of conifer roots are found in the top 500mm of soil, with root networks usually decreasing rapidly below this depth. Excavations below 500mm may require trenches to be shuttered to protect operatives from injury if the walls collapse. Shuttering is likely to preclude retention of roots.
- 11.11 Proposed excavation within the RPA will be conducted by hand and under direct arboricultural supervision. Ideally an air spade should be used but this is often not possible in heavy soils when hand tools will be used instead.
- 11.12 Spoil should be removed from the RPA by hand. Motorised barrows may be used over ground boarding. Spoil may be loaded into the bucket of a digger as long as the digger itself is located outside the RPA and the bucket does not bear on the ground.
- 11.13 Exposed roots will be severed by the project arboriculturist using secateurs or a hand saw to leave a wound of the lowest cross section possible. Exposed roots / cut faces will be protected by damp hessian (dry if frost is likely) and recovered with topsoil at the earliest opportunity. Hessian wraps should be dampened periodically in hot weather.
- 11.14 Protective materials will be removed and backfilling completed as soon as possible once operations are complete. Plastic sheeting will be used to prevent contamination by cement if this is required for adjacent construction.
- 11.15 If roots over 25mm are found the arboriculturist will determine if these may be severed in consultation with the Tree Officer. A record of the works, including photographs and the size and number of roots over 10mm diameter should be produced.

**11.16 Installation of Services (underground and above ground services)**

- 11.17 Since trenching for the installation of underground services severs any roots present and may change the local soil hydrology in a way that adversely affects the health of the tree, in the event of works being required, particular care will be taken in the routeing and methods of installation of all underground services.
- 11.18 If required, the project arboriculturist will discuss the routing of underground services as soon as the requirement is identified. Guidance offered in NJUG will act as reference for working methods.

11.19 Extra precautions will be taken if it is necessary to use concrete near to or within the RPAs of retained trees. This is necessary to prevent potential soil contamination in areas where roots are likely to be present either directly (spillage) or leaching. These include:

- Holes will be excavated by hand;
- An impermeable membrane will be used to line the hole to protect surrounding soil before pouring concrete;
- No concrete is to be mixed within an RPA;
- Excess/spilt concrete will be removed upon completion of works.

11.20 **Additional precautions outside the exclusion zone**

11.21 Planning of site operations will take sufficient account of wide loads, tall loads and plant with booms, jibs and counterweights (including drilling rigs), in order that they can operate without coming into contact with retained trees.

11.22 Such contact can result in serious damage to the trees and might make their safe retention impossible. Consequently, any transit or traverse of plant in proximity to trees will be conducted under the supervision of a banks man, to ensure that adequate clearance from trees is maintained at all times. Access facilitation pruning will be undertaken where necessary to maintain this clearance. NOTE: In some instances LPA consent for pruning may be required.

11.23 Fires are prohibited due to the likely proximity of retained vegetation. NOTE: Local environmental health authorities might also have specific restrictions relating to fires.

11.24 Any materials whose accidental spillage would cause damage to a tree will be stored and handled well away from the outer edge of its RPA. It is essential that allowance will be made for the slope of the ground so that damaging materials such as concrete washings, mortar or diesel oil cannot run towards trees.

---

## 12 Sequencing of works & supervision

12.1 Phase 1a – Pre start – relevant stakeholders to be made aware of AMS and sequencing of works. These include:

- Site Manager (TBC)
- Arboriculturist (B Edmonds – MWA Arboriculture Ltd)
- LPA tree officer
- Engineer
- Appointed tree works contractor

12.2 The agenda of this meeting will cover installation of tree protection mitigation, operating rules, scope of tree works, phasing and landscape operations if information available.

12.3 Phase 1b – Enabling works prior to practical start to be inspected by arboriculturist to include:

- Tree works as per MWA TPP
- Protective fencing as per AMS
- Trouble shooting

12.4 Phase 2 – Demolition phase - monitoring visit(s)

- Position and specification of fencing to be assessed (unscheduled visits)
- Assessment for unauthorised encroachment in exclusion zones (unscheduled visits)
- Supervision of works (if required)
- Trouble shooting with site manager

12.5 Phase 3 – Construction phase - monitoring visit(s)

- Position and Specification of Fencing to be assessed (unscheduled visits)
- Assessment for unauthorised encroachment in exclusion zones (unscheduled visits)
- Supervision of works (if required)
- Trouble shooting with site manager

12.6 Phase 4 – Practical completion and Landscaping (hard and soft)

- Arboriculturist to meet with site manager
- Final monitoring report to be completed

12.7 **SUPERVISION VISITS WILL BE RECORDED USING MWA SITE MONITORING FORM TO BE ACCOMPANIED BY PHOTOGRAPHS. THIS INFORMATION CAN BE MADE AVAILABLE TO THE LPA UPON THEIR REQUEST.**

---

### **13 Conclusions**

- 13.1 Only four trees needed to be removed to enable the development, three of these are in poor condition and the third is a category C tree.
- 13.2 The proposed driveway near Unit C and D does infringe the RPA of T23. This off site tree can be protected by utilising no dig methods and using a cellular confinement system installed according to the manufacturer's specification.
- 13.3 The erection of tree protection fencing and limited ground protection should be sufficient to protect the remaining trees that are to be retained.
- 13.4 Provided that development works take place in accordance with the method statements specified in this report, the works will not be detrimental to the retained vegetation.
- 13.5 All technical issues relating to arboriculture should be addressed to MWA Arboriculture Ltd in the first instance. MWA Arboriculture Ltd will liaise between the Local Planning Authority and any interested parties.
- 13.6 It is suggested that the development proceeds in accordance with the above recommendations with the use of condition(s) to ensure the appropriate methods of working are agreed and any necessary site supervision/enabling works are correctly sequenced prior to the commencement of construction work.

---

**Appendix 1 – Key Contacts**

Position	Organisation	Name	Contact Info
Project Arboriculturist	MWA Arboriculture Ltd	Ben Edmonds	0191 432 9560 <a href="mailto:office@mwaarboriculture.co.uk">office@mwaarboriculture.co.uk</a>
LPA Tree Officer	Hickley & Bosworth Borough Council	TBC	TBC
Site Manager	XL Designs Ltd	Adam	07968 700448

---

**Appendix 2 – Images**



View looking north east, location of Unit A



View looking south, site location for Units B, C & D



Field Maple T20



Crab apple T22 and Ash Tree T21



Maple T23 and Leylandii H1

Arboricultural Monitoring & Supervision Record			
Site Address			
MWA Consultant			
Date of visit			
Also in attendance			
Purpose of Visit			
Monitoring	Supervision	Spot-Check	Meeting
Observations			
	As per AMS/TPP?	Breach?	S Manager aware?
Protective Fencing			
Ground protection			
Signage			
Storage			
Access/egress			
Tree Works			
Underground services			
Comments			
Signed:			
Dated:			

---

Appendix 4 – Example handout for site operatives when working with RPAs



## Precautions When Working Close to Trees



**The following points are designed to prevent damage to both the visible and below ground parts of the tree. Failure to work in line with the points set out below is likely to result in damage to trees and may result in action by the Local Planning Authority such as a stop notice or prosecution.**

- Works stipulated in the approved **Tree Protection Plan** and Arboricultural Report will be completed before other works on the site begin. No other tree pruning is permitted without written permission from the Project Arboriculturist.
- If required **Protective Fencing** is to be installed in accordance with the approved Tree Protection Plan before the start of any construction activities, including demolition or placing of site offices.
- **Protective Fencing** will remain in place until the end of the build unless approval for its removal is provided in writing by the Project Arboriculturist.
- If required **Ground Protection** is to be installed in accordance with the approved Tree Protection Plan before the start of any construction activities, including demolition or placing of site offices.
- **Ground Protection will remain in place** until the end of the build unless approval for its removal is provided in writing by the Project Arboriculturist.
- **Excavations within the Root Protection Areas of retained trees (RPAs)** must be conducted in **strict accordance with the AMS** and in accordance with site specific briefing provided by the Project Arboriculturist.
- Only those **underground services** shown in the approved plans will be routed through the RPA of retained trees without consultation with the Project Arboriculturist. (See above regarding excavation within RPAs.)
- **No storage of chemicals or other materials** is allowed within the RPA of retained trees irrespective of ground protection. Materials should not be stored uphill of retained trees or their RPAs.
- **No mixing of concrete or other potentially toxic materials** is permitted within the RPAs of retained trees.
- **No fires are permitted within RPAs or close to retained trees**, irrespective of local Council policy.
- **Banksman** will be used whenever plant is operating close to retained trees.
- **No plant may operate within the RPA of retained trees** without appropriate ground protection in place.
- Details for the **Project Arboriculturist** may be obtained from the Site Agent.