

FAO: Richardson and Hall Luxury Developments
Date: 02.12.2024

20 CHAPEL STREET, BARWELL: BIODIVERSITY NET GAIN (BNG) SUMMARY

- i. Based on the masterplan and the scheme of applied biodiversity interventions a BNG has not been achieved for area or hedgerow habitats. A summary of the results set out within this assessment and the supporting Statutory Biodiversity Metric calculator tool & figures is provided below.
- ii. The proposed development will result in an overall habitat area unit change of **-0.27**, resulting in an overall net change of **-78.44%** for area habitats. **As such, there is a 0.31 unit deficit required to achieve 10% net gain.**
- iii. The proposed development will result in an overall hedgerow unit change of **-0.05**, resulting in an overall net change of **-100%** for area habitats. **As such, there is a 0.06 unit deficit required to achieve 10% net gain.**
- iv. For full calculation details consult the associated Statutory Natural England Biodiversity Metric calculation spreadsheet which was submit alongside this report. QGIS shapefiles can also be provided upon request.

TRADING SUMMARY

- v. **The trading rules have not been satisfied as part of the assessment.** This component of the metric seeks to secures like for like (or better) habitat compensation and enhancement. Trading issues were identified within medium distinctiveness habitats relating to the loss of other neutral grassland and bramble. As the whole Site will be considered private curtilage post development, it is not possible to include adequate habitat provisions to satisfy the trading rules.
- vi. As no securable habitats were identified a Habitat Management and Monitoring Plan (HMMP) is not considered necessary for the Site.

ACHIEVING BIODIVERSITY NET GAIN

- vii. The applicant intends to achieve the required 10% biodiversity net gain through purchase of off-Site credits via the Environment Bank.



Key

Red Line Boundary

Recently Cleared Ornamental Hedge

Developed land; sealed surface

Modified grassland

Other neutral grassland

JM Ecology

Client

Project Title

Chapel Street

Drawing Title

Baseline Habitat Map

Drawn: JMcL

Reviewed: AM

Project no: JME_2208

Date: 23.10.24

© Copyright JM Ecology Ltd

Drawing Number

JME_2208_DR1_V1

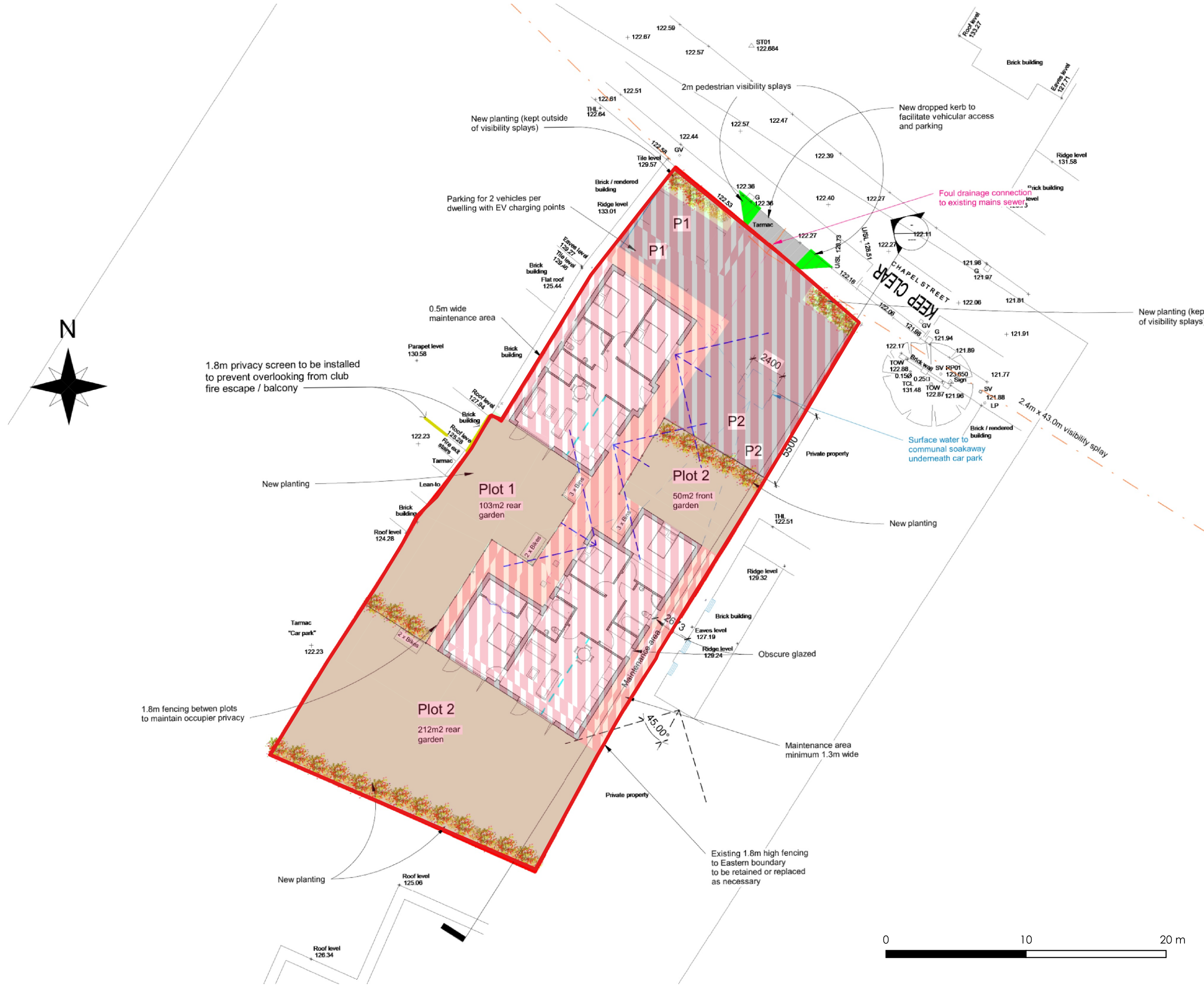

Key

Red Line Boundary

Developed land; sealed surface

Vegetated garden

JM Ecology

Client

Project Title

Chapel Street

Drawing Title

Post Intervention Habitat Map

Drawn: JMcL

Reviewed: AM

Project no: JME_2208

Date: 23.10.24

© Copyright JM Ecology Ltd

Drawing Number

JME_2208_DR2_V1